



Redmayne Arnold & Harris
estate agents, letting agents & surveyors

rah.co.uk



Annexe, 8 Balsham Road, Fulbourn, Cambridge, Cambridgeshire, CB21 5BZ

£1,250

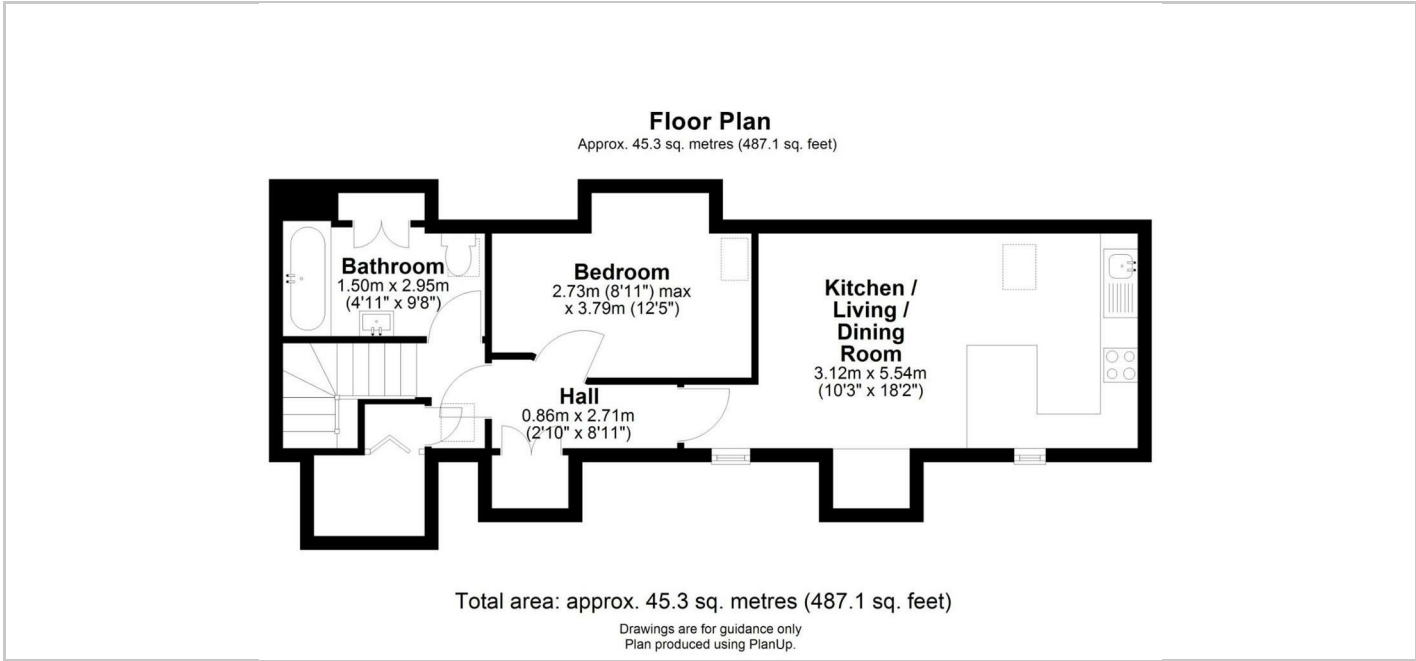

Directions

THE PROPERTY

A well presented one bedroom annexe in the popular village of Fulbourn offering excellent access into Cambridge City Centre, Addenbrookes Hospital, A11, A14 & M11.

The property comprises of a separate entrance, living/kitchen area with breakfast bar, double bedroom and modern bathroom with shower over bath, w.c & basin. There is an enclosed courtyard garden and off-road parking. The property is managed by RAH.

- Council Tax: G
- EPC Band C
- Minimum of 12-month tenancy
- Deposit £1440
- Holding Deposit: £280

SITUATION

